

12 intergovernmental coordination

GOAL 1: Florida Atlantic University will strive to achieve the goals of the master plan through the use of joint processes for collaborative planning, decision making, and development review with the host city, host county, and other regional, state, federal, and special authority agencies. The University is concerned with the impact of its campus development on its context area, as well as the impact of development within the context area on the campus. The context area for the FAU Boca Raton Campus is defined to be the area bounded by Palmetto Park Road on the south, Federal Highway on the east, Yamato Road on the north, and Military Trail on the west (Figure 12.1).

Objective 1A: The University will endeavor to establish a process for the reciprocal review of University campus master plans and local government comprehensive plans and their amendments. In order to accomplish this, FAU will implement the following policies:

- **Policy 1A-1:** The Vice President of Administrative Affairs or delegate shall arrange a series of meetings with the host local government planning officials for the purpose of negotiating the terms and conditions of this reciprocal review process. Every effort shall be made to formalize these terms and conditions through an interlocal agreement or memorandum of understanding.
 - **Policy 1A-2:** Proposed amendments to the adopted campus master plan which exceed the thresholds established in s. 1013.30, F.S., should be submitted to the appropriate local, regional, and state agencies for review.
 - **Policy 1A-3:** Proposed amendments to the adopted campus master plan which do not exceed the thresholds established in s. 1013.30, F.S. and have the potential effect of impacting off-site facilities, services, or natural resources should be submitted to the appropriate local, regional, and state agencies for a courtesy review.
 - **Policy 1A-4:** Proposed amendments to local government comprehensive plans which have the potential effect of changing land uses or policies that guide the development of land within the designated context area, affect the provision of local services, or otherwise impact University facilities and resources should be submitted to the Vice President of Administrative Affairs or delegate for review.
 - **Policy 1A-5:** University planning officials shall continue to meet with officials from the host city and host county on a regular basis, or as the need arises, for the purpose of coordinating planning activities. Other agencies shall be invited to participate in these meetings as necessary.
- Objective 1B:** The University will endeavor to establish a process for the reciprocal review of proposed development activities both on-campus and in the campus context area. The following policies should be implemented:
- **Policy 1B-1:** Upon adoption of the campus master plan update, the University shall negotiate and enter into a campus development agreement as established in s.1013.30, F.S. University planning officials shall cooperate with local officials in the review of proposed campus development to assess potential impacts on local, regional, and state resources and facilities until execution of the campus development agreement.
 - **Policy 1B-2:** Once the campus development agreement is executed, all campus development may proceed without further review by the host local government if it is consistent with the adopted campus master plan and associated campus development agreement.
 - **Policy 1B-3:** The University and host local government will coordinate to plan for and implement compatible development along the boundaries of the campus. Compatibility issues include land use, aesthetics and signage, and development restrictions.
 - **Policy 1B-4:** FAU shall be informed of and permitted opportunities for review and comment on proposed development activities within the University's context areas to assess potential impacts on University resources and facilities.
 - **Policy 1B-5:** Within the negotiated Interlocal Agreement or Memorandum of Understanding shall be provisions requiring the city to transmit to the Vice President of Administrative Affairs or delegate any application for development order or construction permit within the designated context area which exceeds criteria or standards established therein.
 - **Policy 1B-6:** The Vice President of Administrative Affairs or delegate shall assess the potential impacts of proposed projects on FAU facilities and resources. Findings and proposed mitigation of any impacts noted shall be reitted in writing to the appropriate local government planning and development department.

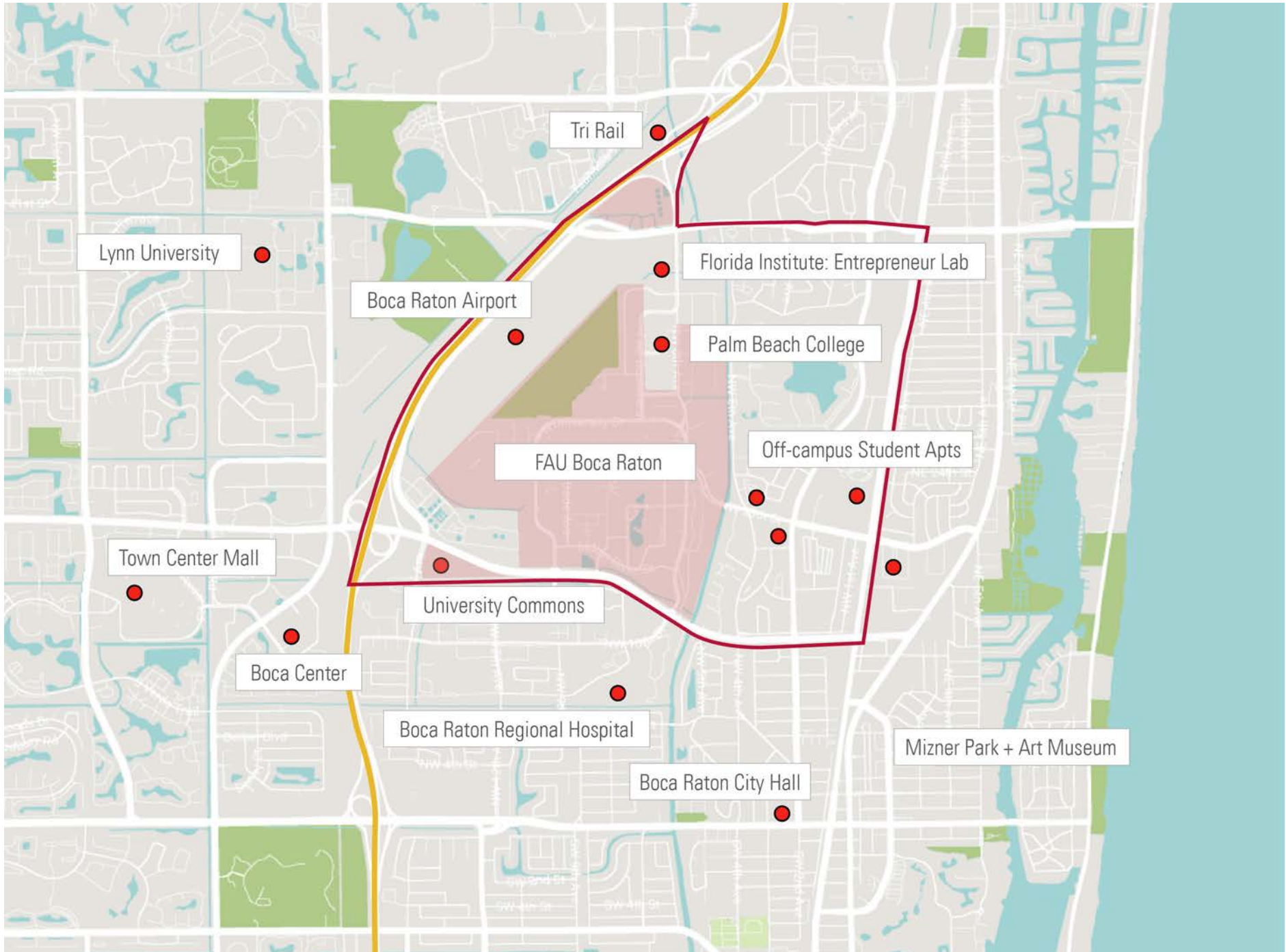

Figure 12.1 Campus Context Area

- **Policy 1B-7:** University and local officials shall cooperate in the identification of appropriate strategies to mitigate the impacts of campus development on local, regional, and state resources and facilities, and to mitigate the impacts of proposed development within the context area on University resources and facilities.
- **Policy 1B-8:** Any dispute between the University and a host local government regarding the assessment or mitigation of impacts shall be resolved in accordance with the process established in s.1013.30, F.S.

INFRASTRUCTURE AND PUBLIC SERVICES

Objective 1C: FAU will endeavor to ensure adequate infrastructure services are coordinated with local government providers to support University functions and facilities.

- **Policy 1C-1:** The University shall participate when requested with local government advisory groups, citizens committees, task forces, local regulatory authorities, and similar groups where issues relating to general infrastructure are considered in order to ensure that University interests are coordinated with local entities.
- **Policy 1C-2:** The appropriate University representatives shall meet with representatives of local and state utilities to resolve issues relating to the maintenance and operation of the utility and infrastructure distribution system and provisions for future capacity.

Objective 1D: FAU will establish level of service standards and concurrency requirements for public facilities, services that interconnect with City facilities, and services for which the City has operational and maintenance responsibility, which are not in conflict with the host city’s level of service standards.

- **Policy 1D-1:** These standards shall include the following items (Standards are established in Element 9, General Infrastructure):
 - Stormwater quantity (Stormwater Management Sub-element)
 - Stormwater quality (Stormwater Management Sub-element)
 - Potable water capacity (Potable Water Sub-element)
 - Sanitary sewage collection and treatment capacity (Sanitary Sewer Sub-element)
 - Solid waste collection and disposal facility capacity (Solid Waste Sub-Element)

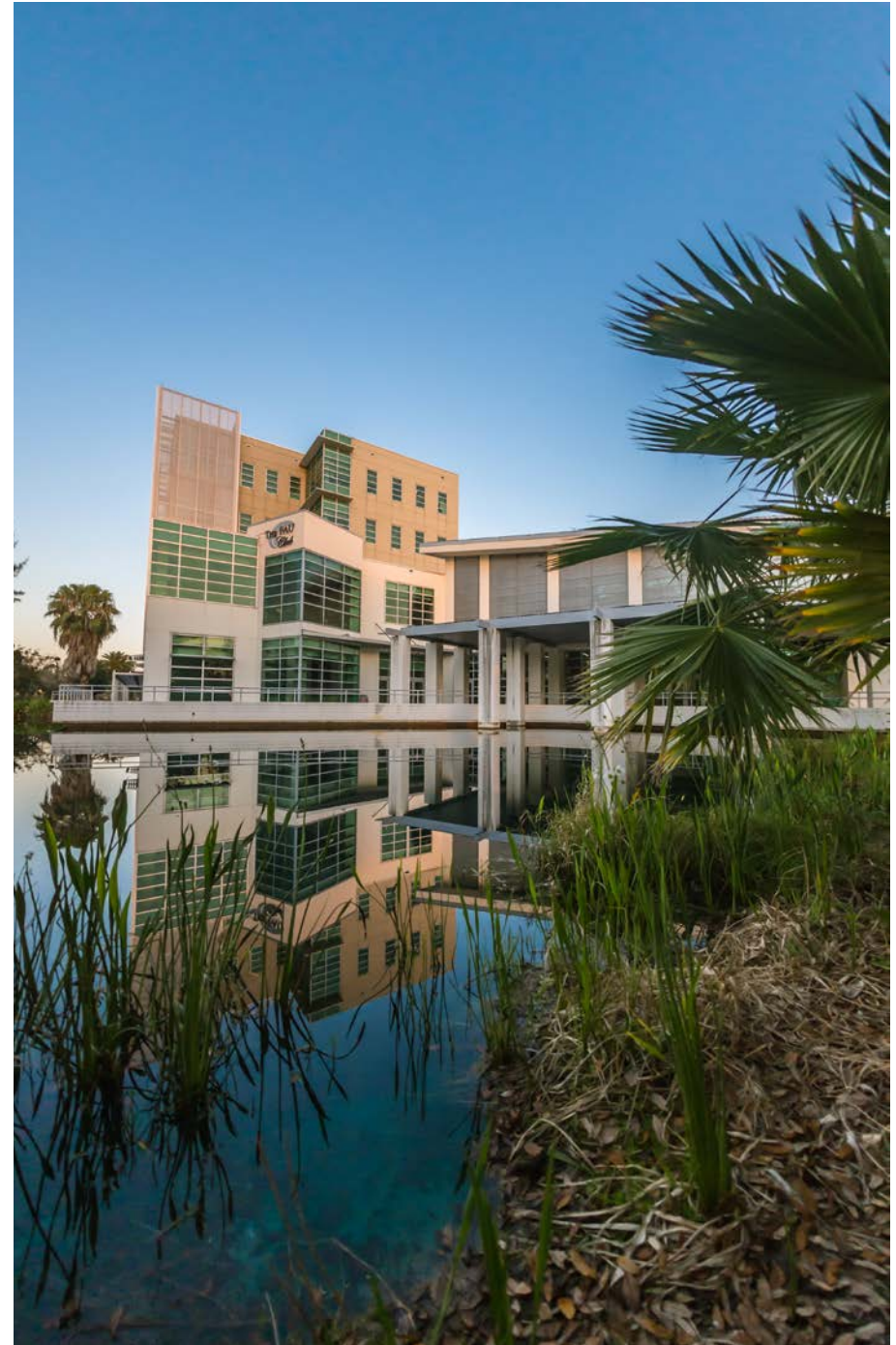



PUBLIC USE OF CAMPUS FACILITIES

Objective 1E: FAU shall continue to coordinate with civic and local government groups concerning the use of University facilities for recreational, entertainment, and other public service events.

- **Policy 1E-1:** The University will continue to support events consistent with availability of resources and facilities.
- **Policy 1E-2:** The University shall continue its policy to recover the cost of special events sponsored by non-University groups, except in those cases where it is determined by the Vice President of Administrative Affairs that the event is of benefit to and in the best interests of the University and the expenditure of University resources is appropriate.

TRANSPORTATION

Objective 1F: The University will endeavor to provide an effective multi-mode transportation system for the University community in cooperation with appropriate local and state government agencies. See element 11, Transportation for further guidance.

SAFETY

Objective 1G: FAU endeavors to provide a safe campus environment for students, faculty, staff, and visitors.

- The University will coordinate long-range planning efforts with fire, public safety, and environmental departments and agencies to maintain and enhance the safety of the campus and its population.