

**PROJECT SCOPE**  
**Parking & Roadway Project**  
**BT-636**  
**Florida Atlantic University**  
MacArthur Campus, Jupiter, FL

**PROJECT HISTORY**

The MacArthur Campus Master Plan was adopted July 10, 1998. Since then much of the planned buildings and infrastructure has been built out in accordance with that master plan. In January, 2006, a five year update was completed and an amendment to the Master Plan was adopted, incorporating The Scripps Research Institute into the plan, while relinquishing certain FAU building rights. A future amendment is planned for 2007 that will make certain adjustments. These adjustments will address the impact of the educational partnership between the Scripps Research Institute and FAU on the University's Academic Program. This amendment is consistent with the University's Mission and its Vision for the MacArthur Campus.

The parking and roadways that make up the BT 636 project are consistent with the adopted Campus Master Plan. See Figure MP.2 below taken directly from the adopted Master Plan.

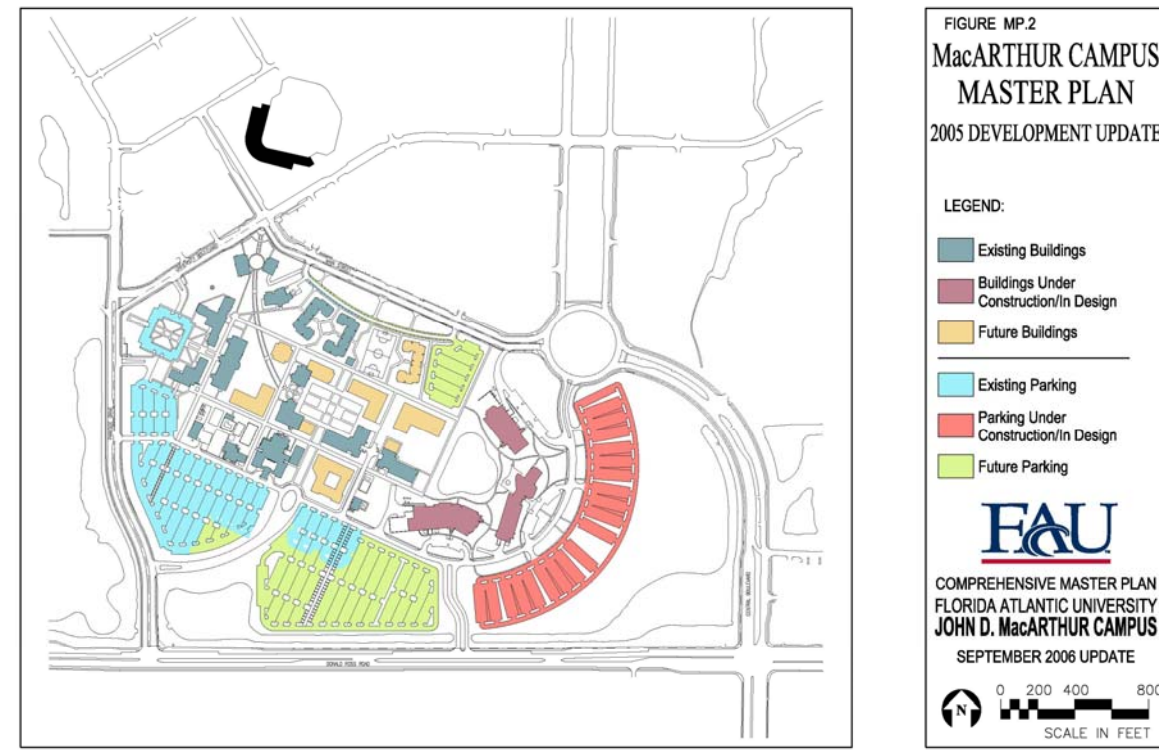

**PROJECT PURPOSE**

The purpose of this parking and roadway project is to provide adequate parking for the existing FAU academic facilities and student housing and to construct a primary arrival road to the center of the developed campus.

## **PROJECT DESCRIPTION & SCOPE**

Located on the MacArthur Campus of Florida Atlantic University in Jupiter, Florida, the parking & roadway project consists of the design of a new two-lane median divided roadway and additional surface parking lots. The parking areas and roadways will include lighting & drainage design, and the master planning of future surface parking areas. Some planning for the enhancement of campus infrastructure within surrounding areas will be included. All work will be in accordance with the approved campus master plan.

The illustration below shows the proposed components of the roadway and parking additions. The two lane entrance drive is of primary importance. The four parking areas shown in yellow will be designed and will be built as the budget allows. Some parking areas and other improvements may be designed and bid as alternates to a base bid.

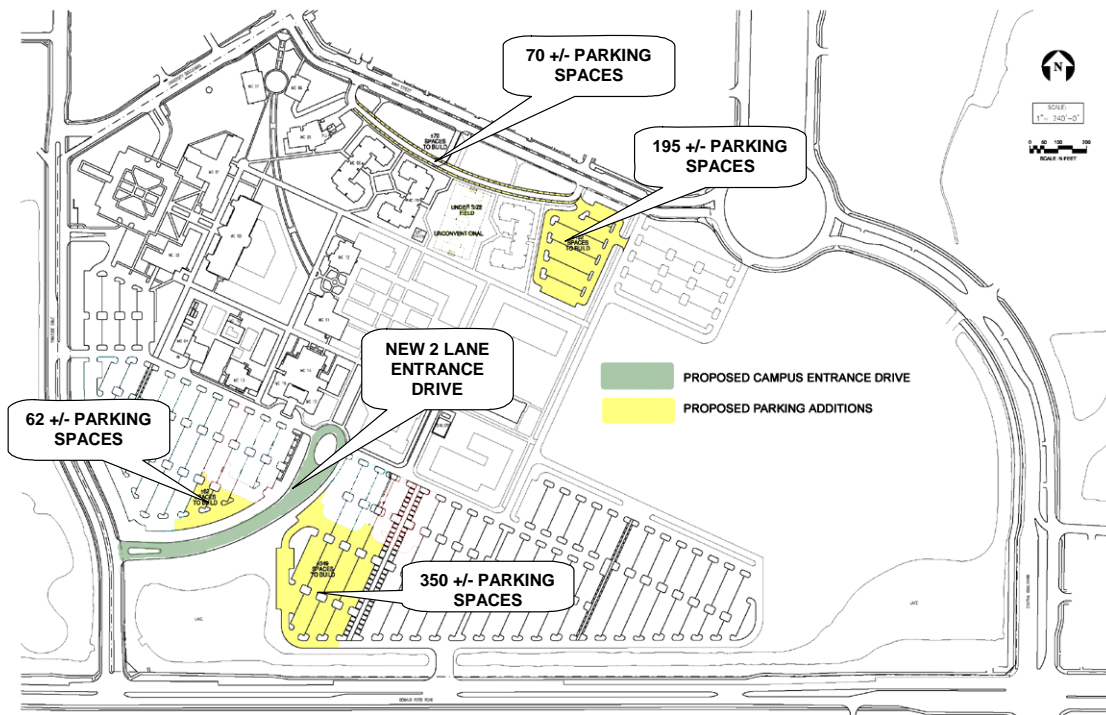

BT – 636 MacArthur Campus  
PARKING & ROADWAY PROJECT



## **PROJECT DELIVERY**

This project will be a conventional design, possibly with add alternate components, and a bid delivery method of construction.

## **PROJECT BUDGET**

The project budget is summarized as follows:

Roadway and Parking Construction	\$1,500,000.00
Other Costs, including Design Fees, Surveys, Permits, Inspections and Internal Contingency	\$300,000.00
<b>Total Project Budget</b>	<b>\$1,800,000.00</b>